



**Hallmark**<sup>™</sup>  
GROUP

# Milano Collection

## CORE OPTION

Particle Board Core



The ultimate in strength, acoustic qualities and impact resistance, the Hallmark solid particle board door is widely used in commercial and high-end residential projects.

# Hallmark Milano Collection

## INTERIOR & SHELTERED EXTERIOR DOORS

### SPECIALTY VENEER DOORS



For a total solid look door but with the stability benefits that an engineered design brings, look no further than the Hallmark Milano Collection. All designs have natural veneer faces bonded to exterior plywood. For grooved designs, solid matching timber inserts are utilised to ensure there is no visible plywood. Clashing strips are fully concealed on the door face. All Milano Collection sheltered exterior doors must have a minimum 1200mm eaves cover. Steel inserts on two sides give the most stable sheltered exterior door available. All designs available for interior applications.

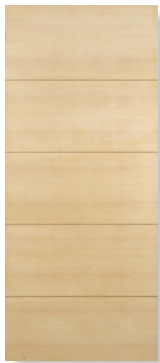

MLN1  
TASI OAK



MLN2  
NZ RIMU

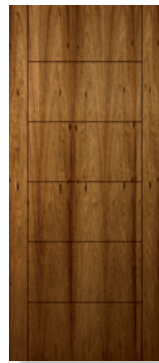

MLN3  
BLACKWOOD



MLN4  
AM. WHITE OAK



MLN5  
JARRAH

(vertical grain flush panel)



MLN6  
TASI OAK

(horizontal grain flush panel)

#### 30 x 30mm STEEL INSERT DETAIL:

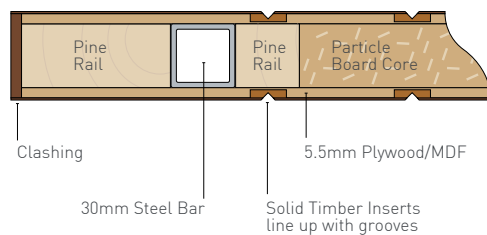

#### 10 x 2mm ROUT DETAIL

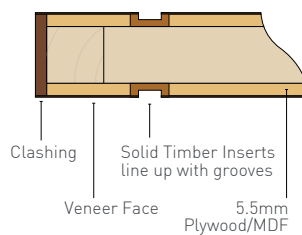

#### 5 x 2.5mm V-GROOVE DETAIL

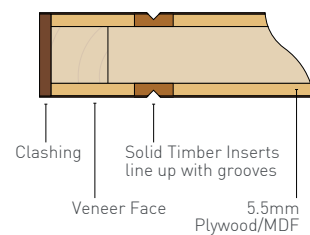

#### ALL DESIGNS AVAILABLE IN ANY OF THE FOLLOWING SPECIES:



Other species available on request.

# Hallmark Door Warranty

All Hallmark doors are covered by the Hallmark Doors Warranty. Hallmark doors are manufactured to strict quality standards and hopefully you never need to make a warranty claim. However all doors are made from timber products and thus are subject to movement. Our warranty covers door movement beyond specified limits.



## Hallmark Interior Doors

### Warranty

Hallmark doors are manufactured with the highest craftsmanship and carry a five-year warranty provided all storage, handling, finishing and hanging instructions are followed.

Hallmark doors are warranted against defects in workmanship and materials, specifically delamination of veneer, or clashings, separation of the skin from the core, veneer splits and excessive distorting from tolerance. The manufacturer will not be held responsible for additional charges of hanging, painting or other charges arising from the replacement of doors.

### Storage and Handling

Inspect all doors upon arrival for freight damage and visible defects. The manufacturer must be notified within four days if damage has occurred. Any claims outside of this time frame cannot be recognised.

- › Show through of any components on a 3mm skin door is not considered a defect.
- › Warp exceeding 5mm shall be considered a defect on doors up to 2400x910mm. This excludes cavity slider doors, see points below.
- › Doors exceeding this size carry no guarantee against warp. The manufacturer will accept no responsibility for defective doors when the moisture content of the timber exceeds 18%.

- › All doors for cavity slider units must have steel inserts to maintain stability. Door leaves up to 1980x810mm require steel inserts on 1 edge, preferably both edges. Door leaves that exceed either 1980mm high or 810mm wide require steel inserts on both edges. Door leaves with steel 2 sides are covered under warranty up to a size of 2700x1210mm. Door leaves exceeding this size are not covered under warranty. Please note that warping less than 5mm is not considered a defect and is not covered under warranty.
- › Doors must be stored flat in a clean, dry area away from direct sunlight. A flat MDF cover sheet must be placed on the top door at all times should it be exposed.
- › Variations in colour are not considered a defect.

### Finishing

When finishing, ensure the door is dry and free from dust and grime. The two faces and all four edges of the door must be sealed and coated (including lock holes and check outs) within four days of arriving on site. Linseed oil or Linseed oil based products are not to be used on any of Hallmark's interior doors. Staining is at your own risk. Hallmark Doors do not accept any liability for the finished quality of a stained door. Coating 'slump' on the veneer joins



is normal and will not be considered a defect. The manufacturer is not liable for the paint finish. Any fibre raise should be sanded flat before coats are applied. Fibre raise is a natural reaction and is not considered a defect.

#### **Installation**

- › All interior doors must be installed in dry buildings only. Doors installed in situations with excessive air movement (i.e. buildings not at 'lock up' stage) void the warranty.
- › Interior doors must not be installed within the direct air movement of an air temperature controller.
- › All doors must have at least three hinges. Doors over 2200mm high must have four hinges.

#### **Care and Maintenance**

Hallmark interior doors are designed for interior use only and should never be used in a situation subject to exterior conditions, high moisture or high temperature fluctuations such as spa or sauna rooms.

Doors installed in bathrooms or laundries that become scratched or damaged are to have the coating repaired immediately. Any repair work must be carried out under the instructions of the coating manufacturer.

#### **Technical Information**

Tolerances:

- +/- 2.0 mm for width, height and thickness
- +/- 3.0 mm for squareness across the diagonal of the door
- +/- 5.0 mm for twisting or bowing

#### **Conditions & Limitations**

The warranty does not apply if:

- › Damage is caused by normal wear and tear or by circumstances outside of Hallmark Doors' control.
- › Installation, storage, handling, maintenance, uses or repairs are not carried out under the manufacturer's instructions.
- › Extra facings such as mirrors, MDF, veneer panelling or similar products are affixed to any face of the door, post manufacture. Other laminate



products such as HPL and vinyl will require prior approval from Hallmark.

#### **Note**

- › Information and specifications may change without notice.
- › Timber colours and grain patterns may vary from those illustrated in our brochure.

## **Hallmark Exterior Doors**

#### **Warranty**

**To be read in conjunction with Hallmark interior doors warranty.** Hallmark exterior doors carry a five year warranty against defects in workmanship, materials and excessive distortion from tolerance. All technical information, storage and handling specifications are as per the Hallmark interior doors warranty. Exterior doors installed in a situation with high temperature fluctuations such as spa or sauna rooms carry no warranty against warp.

#### **Uses**

- › Sheltered exterior with adequate eaves covering. (minimum 1200mm).
- › General interior

#### **Limitations**

- › Unprotected exterior use
- › Saunas, steam rooms, smoke houses etc.
- › Fire doors

#### **Finishing**

Exterior finishes must be used on all exterior doors. All doors must be fully painted with a full coating system prior to site installation. Exterior doors must not be painted in dark colours as these colours tend to absorb more heat and may cause the door to distort. A light colour has a Light Reflectance Value (LVR) greater than 40 (white is 100, black is zero). Refer to your paint manufacturer for further advice.

Note: dark colours on any exterior door will void the warranty.





[www.hallmarkgroup.co.nz](http://www.hallmarkgroup.co.nz)

Phone: 0800 846 237

Email: [sales@hallmarkgroup.co.nz](mailto:sales@hallmarkgroup.co.nz)